



BOSCH

LOCK-IN SECURITY

Fast and secure wheel-to-grinder connection

Bosch metal-cutting and grinding abrasive wheels with the X-Lock mount offers a wheel change that's five times faster than conventional interfaces. X-Lock wheels are ejected with a lever pull and firmly connected without the need for a spanner wrench or flange nuts. There's an audible snap when mounting an X-LOCK Wheel on an X-LOCK grinder. The wheel mounts properly without the need for a spanner wrench or flange nuts.

#BOSCHXLOCK

XLOCK



X-Lock is a registered trademark of the U.S. Patent and Trademark Office



Concrete Cutting



Metal Grinding



Rebar Cutting

For additional applications and corresponding accessories, see next page



USER SCENARIOS

"I change wheels frequently during one job."

"I've lost my spanner wrench more times than I can count."

"I want to make sure my wheel is secure all day."

OPTIMAL FOR (TRADES)



BOSCH VALUE

- ▶ Up to 5X faster wheel, disc changes
- ▶ World's first quick-change angle grinder interface
- ▶ Gradual fleet transition possible with certain backwards compatible X-Lock accessories

| MODEL NO. | SIZE | CORDED | CORDLESS | POWER | HANDLE FEATURE |
|--------------|-------------------|--------|----------|---------------|-----------------------|
| GWX10-45E | 4 1/2 in. | X | | 10 Amp | Side Switch |
| GWX10-45PE | 4 1/2 in. | X | | 10 Amp | Paddle Switch |
| GWX10-45DE | 4 1/2 in. | X | | 10 Amp | Dead Man's Switch |
| GWX18V-50PCN | 4 1/2 in. - 5 in. | | X | 18V (~10 Amp) | Paddle Switch |
| GWX13-50 | 5 in. | X | | 13 Amp | Side Switch |
| GWX13-50VSP | 5 in. | X | | 13 Amp | Variable Speed Paddle |

Accessories listing on next page



QUICK-CHANGE

Minimizes downtime between wheel changes with zero losable parts



BACKWARDS COMPATIBLE

Most Bosch X-Lock wheels are backwards compatible with standard 7/8 in. mounts



TOOL-FREE SYSTEM

Single lever wheel ejection without need of a spanner wrench



ERGONOMIC DESIGN

Robust for metal and concrete work combined with Bosch-proven ergonomic design

[CLICK HERE TO LEARN MORE](#)



BOSCH



LOCK-IN SECURITY

Fast and secure wheel-to-grinder connection

up to **5X FASTER WHEEL CHANGE** vs. standard 7/8 in. mount

ATTACH

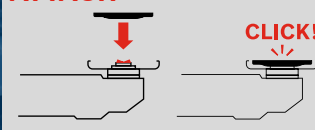

CLICK!

REMOVE



CLICK!

#BOSCHXLOCK

XLOCK



X-LOCK is a registered trademark of the U.S. Patent and Trademark Office



Wide range of accessories for various applications
Grinders listing on previous page

CLICK HERE TO LEARN MORE

| MODEL NO. | DESCRIPTION | ACCESSORY TYPE |
|-------------|--|----------------|
| WBX409 | 4 in. Wire Wheel, Stringer Bead Knotted, Stainless Steel | Wire Wheels |
| FBX4524 | Fiber Discs 4-1/2 in. x 24 grit | Fiber Disc |
| FBX4536 | Fiber Discs 4-1/2 in. x 36 grit | Fiber Disc |
| FBX4560 | Fiber Discs 4-1/2 in. x 60 grit | Fiber Disc |
| FBX4580 | Fiber Discs 4-1/2 in. x 80 grit | Fiber Disc |
| FBX45100 | Fiber Discs 4-1/2 in. x 100 grit | Fiber Disc |
| FBX45120 | Fiber Discs 4-1/2 in. x 120 grit | Fiber Disc |
| FBX524 | Fiber Discs 5 in. x 24 grit | Fiber Disc |
| FBX536 | Fiber Discs 5 in. x 36 grit | Fiber Disc |
| FBX560 | Fiber Discs 5 in. x 60 grit | Fiber Disc |
| FBX580 | Fiber Discs 5 in. x 80 grit | Fiber Disc |
| FBX5100 | Fiber Discs 5 in. x 100 grit | Fiber Disc |
| FBX5120 | Fiber Discs 5 in. x 120 grit | Fiber Disc |
| FDX2745040 | Flap Discs 4-1/2 in. - 40 Grit | Flap Disc |
| FDX2745060 | Flap Discs 4-1/2 in. - 60 Grit | Flap Disc |
| FDX2745080 | Flap Discs 4-1/2 in. - 80 Grit | Flap Disc |
| FDX27450120 | Flap Discs 4-1/2 in. - 120 Grit | Flap Disc |
| FDX2750040 | Flap Discs 5 in. - 40 grit | Flap Disc |
| FDX2750060 | Flap Discs 5 in. - 60 grit | Flap Disc |
| FDX2750080 | Flap Discs 5 in. - 80 grit | Flap Disc |
| FDX2750120 | Flap Discs 5 in. - 120 grit | Flap Disc |
| DBX4543S | 4-1/2 in. Continuous Diamond Blade | Diamond Blade |
| DBX543S | 5 in. Continuous Diamond Blade | Diamond Blade |
| DBX4541S | 4-1/2 in. Segmented Diamond Blade | Diamond Blade |
| DBX4541P | 4-1/2 in. Premium Segmented Dia. Blade | Diamond Blade |
| DBX541P | 5 in. Premium Segmented Dia. Blad | Diamond Blade |
| DBX4541E | 4-1/2 in. Xtreme Segmented Dia. Blade | Diamond Blade |
| DBX541E | 5 in. Xtreme Segmented Dia. Blade | Diamond Blade |
| MGX0450 | 4-1/2 in. Backing Pad w/Clip Med. Hardness | Pads |
| MGX0500 | 5 in. Backing Pad w/Clip Medium Hardness | Pads |
| MGX0100 | Individual Clip | Pads |

| MODEL NO. | DESCRIPTION | ACCESSORY TYPE |
|------------|--|-----------------|
| CWX27M450 | Metal Cutting T27 4-1/2 in. x 0.098 in. | Bonded Abrasive |
| CWX27M500 | Metal Cutting T27 5 in. x 0.098 in. | Bonded Abrasive |
| CWX1M450 | Masonry Cutting T1 4-1/2 in. x 1/16 in. | Bonded Abrasive |
| CWX1M500 | Masonry Cutting T1 5 in. x 1/16 in. | Bonded Abrasive |
| TCWX1S450 | Metal & Stainless Steel Thin Cutting T1 4-1/2 in. x .045 in | Bonded Abrasive |
| TCWX1S500 | Metal & Stainless Steel Thin Cutting T1 5 in. x .045 in. | Bonded Abrasive |
| TCWX27S450 | Metal & Stainless Steel Thin Cutting T27 4-1/2 in. x .045 in | Bonded Abrasive |
| TCWX27S500 | Metal & Stainless Steel Thin Cutting T27 5 in. x .045 in. | Bonded Abrasive |
| GWX27LM450 | Metal Grinding T27 4-1/2 in. x 1/4 in. | Bonded Abrasive |
| GWX27LM500 | Metal Grinding T27 5 in. x 1/4 in. | Bonded Abrasive |
| GWX27M450 | Masonry Grinding T27 4-1/2 in. x1/4 in. | Bonded Abrasive |
| GWX27M500 | Masonry Grinding T27 5 in. x 1/4 in. | Bonded Abrasive |
| WBX318 | 3 in. Cup Brush, Crimped, Carbon Steel | Cup Brush |
| WBX319 | 3 in. Cup Brush, Crimped, Stainless Steel | Cup Brush |
| WBX328 | 3 in. Cup Brush, Knotted, Carbon Steel | Cup Brush |
| WBX329 | 3 in. Cup Brush, Knotted, Stainless Steel | Cup Brush |
| WBX418 | 4 in. Wire Wheel, Crimped, Carbon Steel | Wire Wheel |
| WBX428 | 4 in. Wire Wheel, Knotted, Carbon Steel | Wire Wheel |
| WBX429 | 4 in. Wire Wheel, Knotted, Stainless Steel | Wire Wheel |
| WBX408 | 4 in. Wire Wheel, Stringer Bead Knotted, Carbon Steel | Wire Wheel |